

TRANSCEIVERS

OPTICAL TRANSCEIVERS

Quick Start Guide **V1.0**

1

Safety Information

○ Note ○ Warning



Caution against moisture.



Do not disassemble
or modify.



The transceiver can only be
installed or replaced by
qualified personnel.



Please wear antistatic
gloves.



Never look into fiber ports.

2

Product View

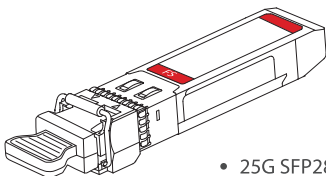

- 25G SFP28
- 25G BiDi SFP28
- 25G WDM SFP28
- 10G SFP+
- 10G BiDi SFP+
- 10G WDM SFP+
- 1000BASE SFP

- 100G QSFP28
- 50G QSFP28
- 50G BiDi QSFP28
- 40G QSFP+
- 40G BiDi QSFP+

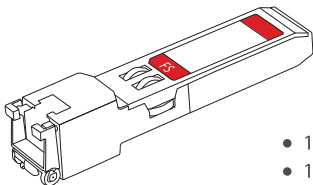
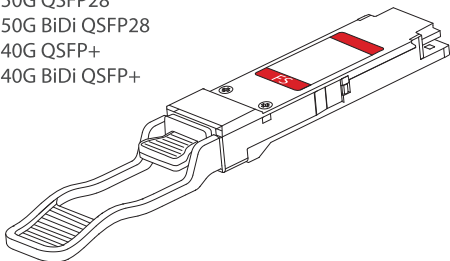

- 1000 BASE-T SFP
- 10G BASE-T SFP+

3

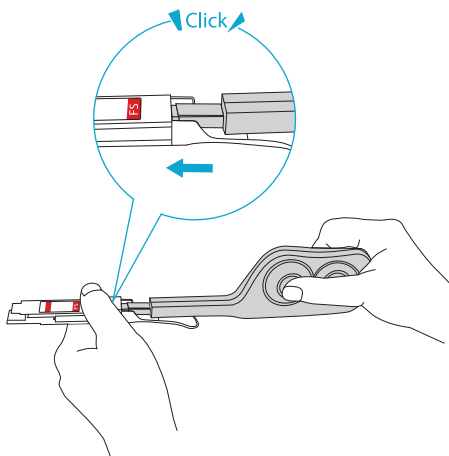
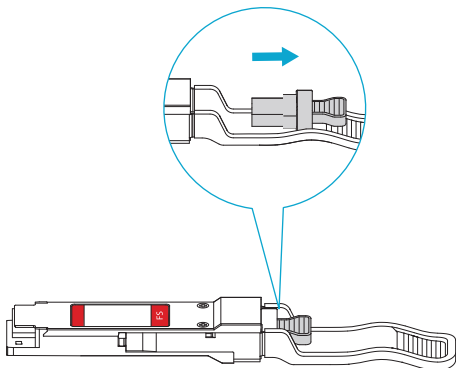

4

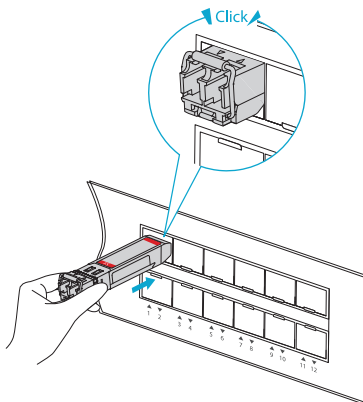

NOTE: Line up the module with the port and slide it gently into the port until the lock is fully seated.

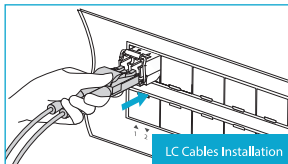
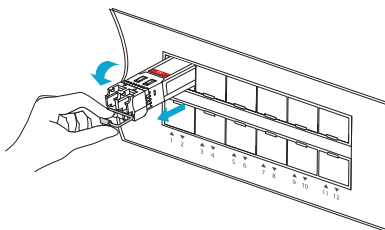

5

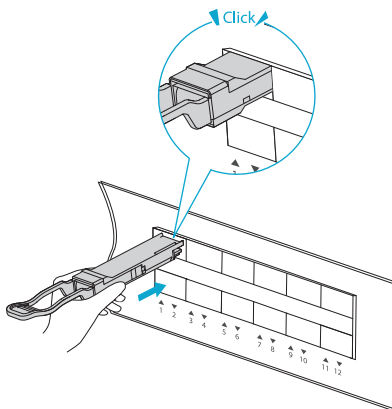

NOTE: When inserting a QSFP+ module, the label needs to face down.

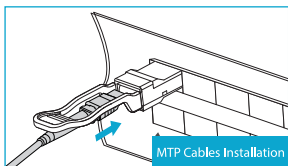
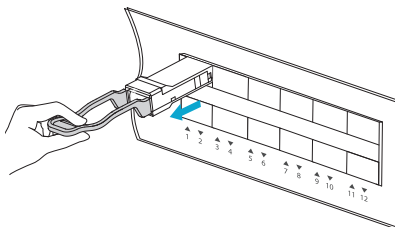

6

Product Warranty

FS ensures our customers that any damage or faulty items due to our workmanship, we will offer a free return within 30 Days from the day you receive your goods. For Fiber Optic Transceivers, we also offer replacement service if there are any quality issues within 1 year.



Warranty: All Fiber Optic Transceivers enjoy 5 years limited warranty against defect in materials or workmanship. For more details about warranty, please check at **<https://www.fs.com/policies/warranty.html>**



Return: If you want to return item(s), information on how to return can be found at **https://www.fs.com/policies/day_return_policy.html**

Q.C. PASSED